

VEGA



Always consult www.augentilighting.it for
UPDATED TECHNICAL DATA



VEGA



APPLICATION



Adjustable luminaire suitable to be installed on the wall, ceiling or on the ground as a stand-alone projector or with spike support. Equipped with secondary optics for different light distributions, it is composed of an insulating base (or picket) in PC that allows you to install the fixture directly on the ground without oxidation phenomena. All versions integrate a quick rotation / adjustment system on the horizontal plane by means of a toothed ring nut, without using any tools. LED source with built-in driver. Available Dali dimmable on request with extra charge.

CHARACTERISTICS

- Adjustable luminaire on two vertical/horizontal planes with screw tightening.
- Optical/Driver section not accessible during installation.
- Separate driver compartment accessible through the base with IP68 cable gland.
- Connection to the power supply network M16 cable gland for cables with a maximum diameter of 10mm, type H07RN-F 3x1.5 or similar.
- Connection terminal block inside the driver compartment.
- Version with COB LED with direct power supply in AC 230V.
- LED maintenance can be carried out by removing the optical compartment (3 screws).
- Driver maintenance by disassembling the base.
- Fixed or Dali dimmable system for monochromatic LEDs.
- RGBW system for multichip LEDs with remote control.
- Luminaire Conforms to EN60598-1 Standard and special requirements

MATERIALS

- Body in die casting aluminium alloy.
- Base in molded Polycarbonate (PC)UV resist. GWT960°C
- Extra Clear Tempered Glass 4mm with silk-screen printing. - trasmissione LT>90%.
- Seals in EDPM closed cell rubber, UV- resist. Tx -40/+150°C.
- Integrated passive heat sink made of aluminium alloy
- Internal and external screws in A2 Stainless Steel
- Polyester powder coating, UV-stabilised with anti-corrosion treatment.

VEGA

SPECIFICATIONS

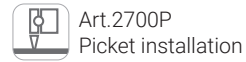

- The rated flux values refer to source LED at Ts85°C / ta25°C
- The Power/Flux in the table refer to maximum installable value
- Lower powers are available on request, only for version with built-in driver
- Dimmable system available on request only with built-in driver
- 2700P supplied with plastic stake PA6
- Supplied with 3x1mm² cable 300mm long
- **IP68 connector available on request**



LED SYSTEM WITH BUILT-IN DRIVER

COD.	Source Flux	Fixture Flux	CCT	CRI	Power	CL
2700W/WC35.XX	1835 lm	1288 lm	3000 K	80	14W 220-240Vac 50/60Hz	I
2700W/NC35.XX	1925 lm	1351 lm	4000 K	80	14W 220-240Vac 50/60Hz	I
2700P/WC35.XX	1835 lm	1288 lm	3000 K	80	14W 220-240Vac 50/60Hz	I
2700P/NC35.XX	1925 lm	1351 lm	4000 K	80	14W 220-240Vac 50/60Hz	I

Beam
 XX=NB (Spot 18°)
 XX=MB (Flood 29°)
 XX=WB (Wide Flood 38°)

Adjustable Direct Emission
 Silk-Screen Clear Glass

Dali dimmable on request
 with extra charge

DIMENSIONS

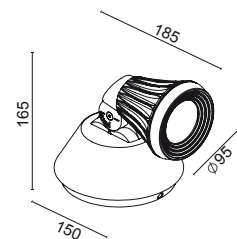

2700W

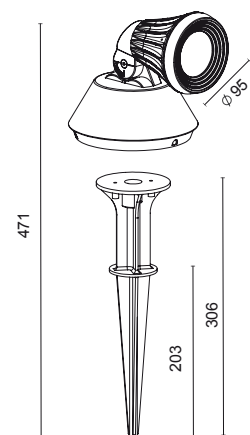

2700P

ASSEMBLY

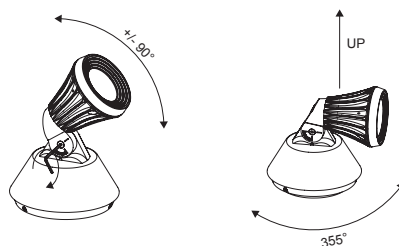
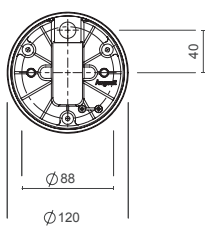

ACCESSORIES



AC2700
 Anti-glare visor in AISI430F steel,
 polyester powder coated
 Screws included

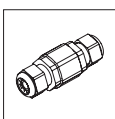

MOR683P/2V
 IP68 2ways/3poles connector.
 Maximum section 3x2.5mm

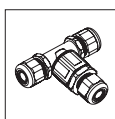

MOR683P/3V
 IP68 3ways/3poles branch
 connector. Maximum section
 3x2.5mm

STANDARD COLOURS

